

Welcome to the Stone Deck Revolution

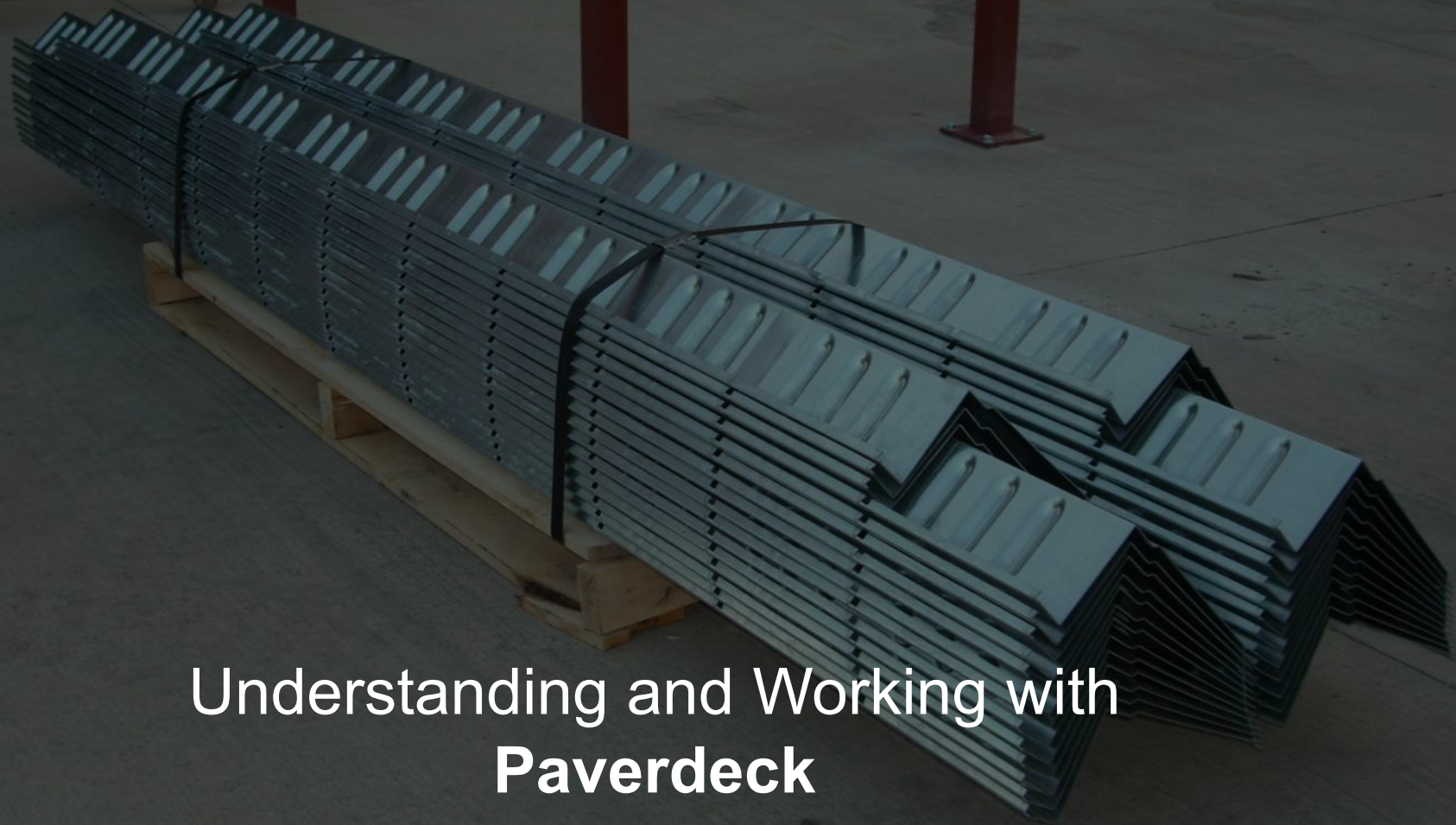

Maintenance-Free Decks for a Lifetime



Understanding and Working with
Paverdeck

PAVERDECK™
Your Best Deck Investment.

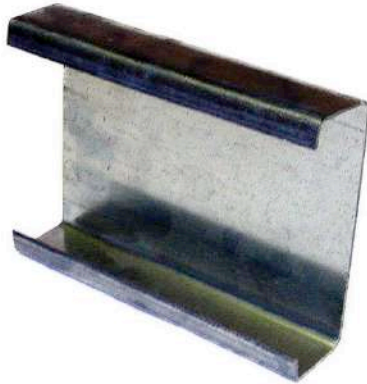

STARTER C-CHANNEL. The 6.0 inch Starter Channel is used to start the deck, usually at a wall. Screw the Starter Channel to the Beam at the intersection points with the beam.

PAVERDECK™
Your Best Deck Investment.



BEAM. The 10-inch beam is sized to match the maximum span of your specific kit.

Understanding Paverdeck Components

PAVERDECK™
Your Best Deck Investment.



FIELD PANEL. The 6.25 inch high Field Panel is screwed to the Starter Channel on one end and also to each Beam at the intersection point. Keep adding Field Panels in the same manner until you reach the desired dimension.

PAVERDECK™
Your Best Deck Investment.



END PANEL. The End Panel is screwed to the last Field Panel to complete the deck platform. Also screw the End Panel to each Beam at the intersection point.

Understanding Paverdeck Components

 **PAVERDECK™**
Your Best Deck Investment.

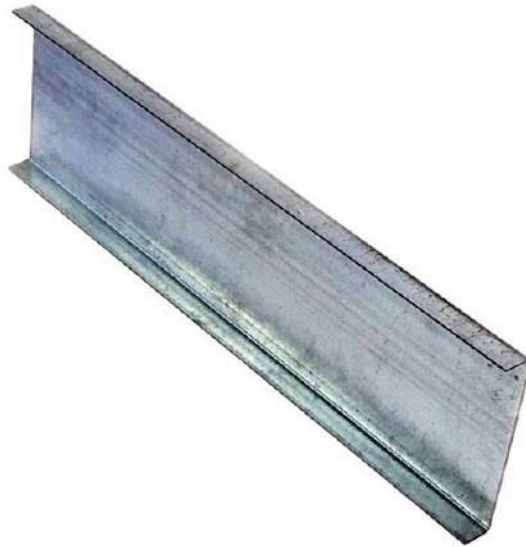

FASCIA CAP. The cap covers the open exposed face of the deck and is used to attach your fascia trim.



Understanding Paverdeck Components

Paverdeck Component Layout

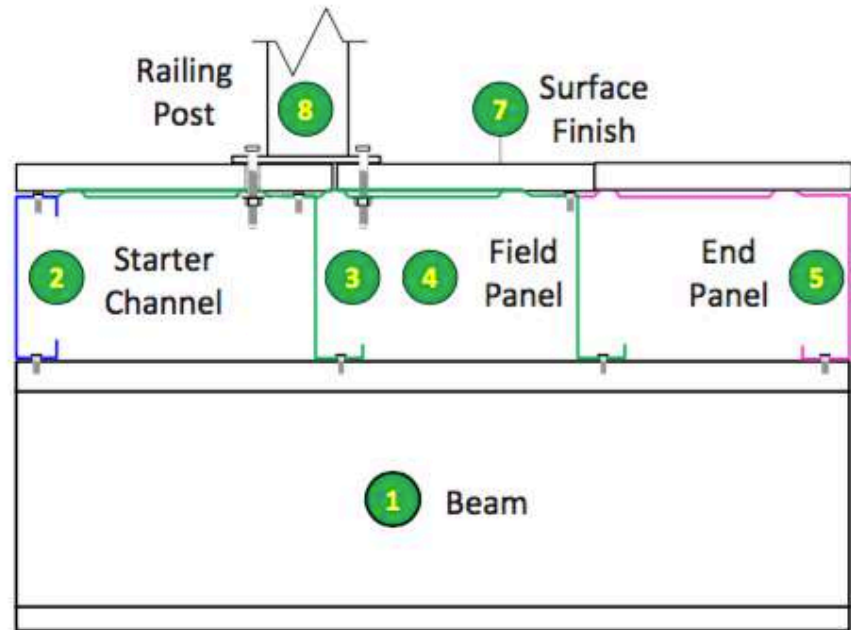
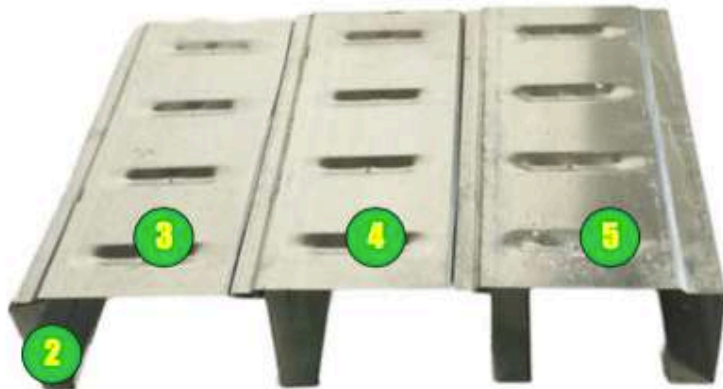
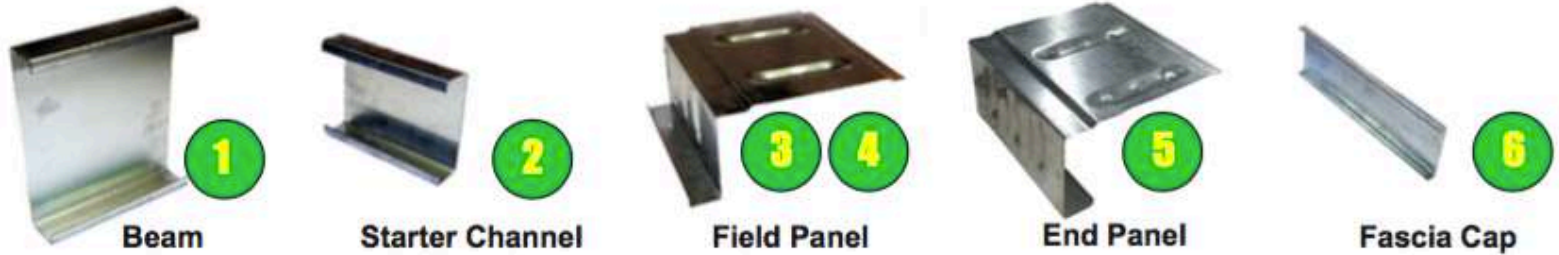

A solid foundation is key for any deck

Using galvanized screw piles provide a solid foundation with certified engineering



Flat plates are used for easier alignment of beams when being installed



Attaching the beam on top of the piles

Beams are attached to pile plate using Hilti X-U 16 or 19 nail fastener



Over each pile a beam stiffener is installed using 4 Tek Screws



A lintel may be used if required

4" x 4" x 1/4" steel lintel is attached to the foundation

Lintel attached every 12" using Hilti KB3 1/2" x 3-3/4" LT fasteners



Occasionally, the elevation of the deck requires the lintel being positioned too close to the top of the foundation causing concerns for the concrete possibly cracking. In this case the lintel may be positioned lower, at the same level as the screw pile tops and a **Paverdeck** beam secured on top.



Start assembly by attaching a C-channel

A C-channel is sometimes referred to as a starter channel

C-channel is attached to the lintel and beam using appropriate fasteners



C-channel is attached to two beams using appropriate fasteners



Assembly proceeds by attaching the field panels using the appropriate fasteners

Field panels are sometimes referred to as Z-panels



Choosing appropriate fasteners makes assembly quick and easy

When attaching Paverdeck components to each other, use the supplied Tek Screws



When attaching Paverdeck components to steel, use Hilti Nail Fasteners



Assembly continues using all field panels, and the deck is completed with an end panel

The end panels are sometimes referred to as a “C”s

Two Tek Screws are installed at the ends
then one screw in every second dimple

The end panel, like the C-channel, provide
a straight clean surface for stone cladding



Each panel allows for a ½” adjustment to ensure the deck runs straight and true. This also allows for some adjustment, so the deck ends where desired. In some cases, one or more field panels may require trimming lengthwise.

The last field panel before the end panel is trimmed to the required width

Cuts must be made within the grooved area atop of the panels to seat the screws



Open ends are enclosed using the fascia or capping panels secured using the supplied capping screws



PAVERDECK BOX STAIRS

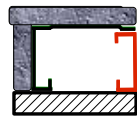
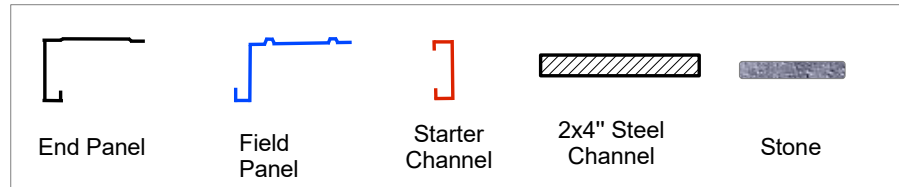

Single Step

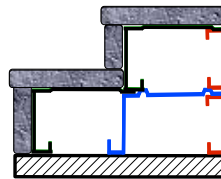

2 Steps

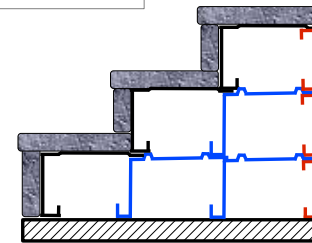

3 Steps

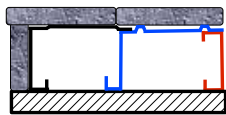

Double Depth

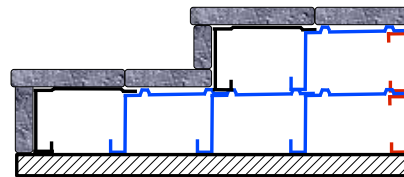

2 Steps - Double Depth

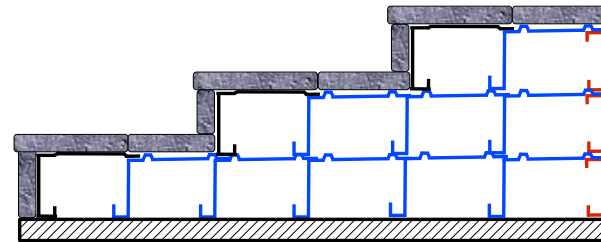

3 Steps - Double Depth

Note: Field panels can be cut to accommodate custom widths of stair treads
2X4" Steel Channel only used on ground construction and is not required
when assembled on PAVERDECK.

For discussion purposes only

Box stair construction method



PAVERDECK STAIR KIT

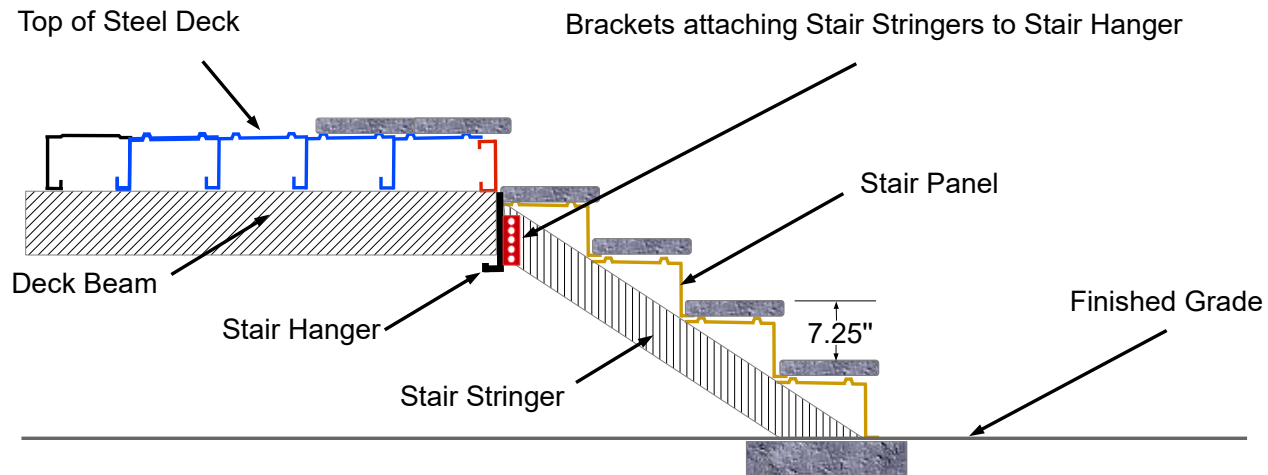

Standard Stair Kit - 4 step example shown
Available in 2 - 10 step kits

For discussion purposes only

Paverdeck stair kit method

Stair kits come with all required hardware and fasteners

A piece of beam is attached to the bottom of the deck structure to secure stringers



Stringers are cut from either a beam or a C-channel and secured as prescribed



Paverdeck stair kit method

Stair kits come with all required hardware and fasteners

A piece of 2 x 4 steel is secured to the beam section between the stringers



The stair panels are then secured from the top down



Side Cladding a Paverdeck

Galvanized framing members are used to build a wall system around the deck



1/2" cement board is attaching to the framed wall system



Side Cladding a Paverdeck

Selected stone is then adhered to the cement board





Side cladding options are endless

Optional Anode for extra corrosion protection

Each anode will offer additional protection for up to 250 sq ft of decking

The anode is easily installed to the underside of the deck











References

Paverdeck Installation Guide

<http://stonedeck.ca/wp-content/uploads/2016/12/PAVERDECK-INSTALLATION-GUIDE-2016.pdf>

Canadian Specifications

<http://stonedeck.ca/wp-content/uploads/2018/04/2016-EDECK625S1200-054-CANADA.pdf>

UL – Code Evaluation Report

<http://stonedeck.ca/wp-content/uploads/2018/04/ULR38320-20161125-Report-Evaluation-1.pdf>

Hilti Nail Fasteners

<https://www.hilti.ca/direct-fastening/general-purpose-powder-actuated-systems/r6220>

Hilti Expandable Fasteners

<https://www.hilti.ca/anchor-fasteners/expansion-anchors/r6294>

Postech Helical Piles

<https://postech-foundations.com/thermal-piles/>

**Isn't it time for
you to join the
Stone Deck
Revolution?**



STONEDECK™

INNOVATIONS